

HSK063A End Mill Adapters

Features

- 3 μm - 0.0001" Bore Runout
- H5 Bore Tolerance or better
- Coolant Thru
- Pre-Balanced for use @ 20,000 RPM
(HSK100A @ 15,000 RPM)

Optional (Order Separately):

- Jet-Blast (add "J" to the part number)

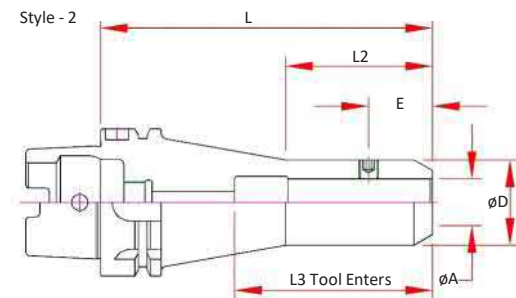
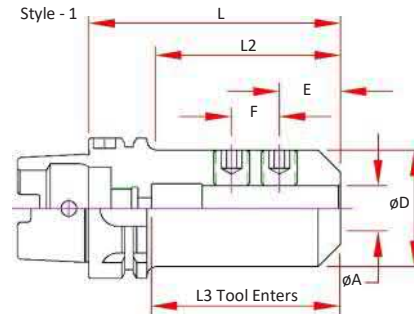

Part Number	A Bore	D	E	F	L Projection	L2	L3 Max. Tool Enters	Screw Number	Style
HSK063A-EM012-0250	0.1250	0.69	0.19	-	2.50	1.28	1.63	3	1
HSK063A-EM012-0400	0.1250	0.69	0.19	-	4.00	2.78	1.63	3	1
HSK063A-EM012-0600	0.1250	0.69	0.19	-	6.00	2.50	1.63	3	2
HSK063A-EM018-0400	0.1875	0.69	0.44	-	4.00	2.78	1.63	3	1
HSK063A-EM018-0600	0.1875	0.69	0.44	-	6.00	2.50	1.63	3	2
HSK063A-EM025-0250	0.2500	0.78	0.44	-	2.50	1.28	1.63	4	1
HSK063A-EM025-0400	0.2500	0.78	0.44	-	4.00	2.78	1.63	4	1
HSK063A-EM025-0600	0.2500	0.78	0.44	-	6.00	2.50	1.63	4	2
HSK063A-EM031-0250	0.3125	0.88	0.44	-	2.50	1.28	1.63	4	1
HSK063A-EM031-0400	0.3125	0.88	0.44	-	4.00	2.78	1.63	4	1
HSK063A-EM031-0600	0.3125	0.88	0.44	-	6.00	3.00	1.63	4	2
HSK063A-EM037-0250	0.3750	1.00	0.75	-	2.50	1.28	1.50	5	1
HSK063A-EM037-0400	0.3750	1.00	0.75	-	4.00	2.78	1.50	5	1
HSK063A-EM037-0600	0.3750	1.00	0.75	-	6.00	3.00	1.50	5	2
HSK063A-EM050-0315	0.5000	1.25	0.88	-	3.15	1.93	2.10	6	1
HSK063A-EM050-0400	0.5000	1.25	0.88	-	4.00	2.78	2.10	6	1
HSK063A-EM050-0600	0.5000	1.25	0.88	-	6.00	3.00	2.10	6	2
HSK063A-EM062-0315	0.6250	1.50	0.94	-	3.15	1.93	2.10	7	1
HSK063A-EM062-0400	0.6250	1.50	0.94	-	4.00	2.78	2.10	7	1
HSK063A-EM062-0600	0.6250	1.50	0.94	-	6.00	4.78	2.10	7	1
HSK063A-EM075-0315	0.7500	1.75	1.00	-	3.15	2.08	1.97	8	1
HSK063A-EM075-0400	0.7500	1.75	1.00	-	4.00	2.94	1.97	8	1
HSK063A-EM075-0600	0.7500	1.75	1.00	-	6.00	4.94	1.97	8	1
HSK063A-EM100-0400	1.0000	2.00	1.12	1.00	4.00	2.94	2.95	(2) 10	1
HSK063A-EM100-0600	1.0000	2.00	1.12	1.00	6.00	2.94	2.95	(2) 10	1
HSK063A-EM125-0435	1.2500	2.81	1.12	1.00	4.35	3.32	3.23	(2) 11	1

CAT40
CAT50
BT30
BT40
HSK 40E
HSK 63A
HSK 100A
STRAIGHT SHANKS
COLLETS
PARTS & ACCESS.
SHRINK MACHINES
INDEXERS

