

CAT40 Shell Mill Adapters

Features

- 3 μm - 0.0001" Bore Runout
- H5 Bore Tolerance or better
- Tapers are ground better than AT3 for optimal T.I.R.
- Coolant Thru Body
- Pre-Balanced for use @ 20,000 RPM

Optional (Order Separately):

- FX Coolant (add "F" to the part number)
- DIN-B Coolant (Select models)

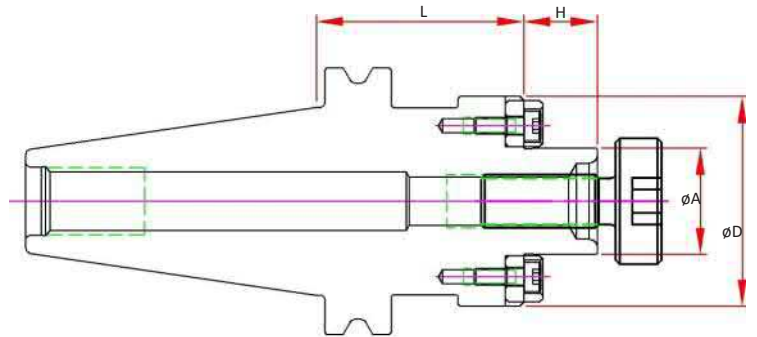

Dual Contact Spindle Part Number	Standard Spindle Part Number	A Pilot	D	H	L Projection	Drive Key Size	Drive Key Number	Mounting Screw Thread	Mounting Screw#
CAT40-SM050-0175-B	CAT40-SM050-0175				1.75				
CAT40-SM050-0400-B	CAT40-SM050-0400	0.500	1.38	0.57	4.00	0.250	DK-SM050	1/4-28	SCW-SM050
CAT40-SM050-0600-B	CAT40-SM050-0600				6.00				
	CAT40-SM050-0900				9.00				
CAT40-SM075-0175-B	CAT40-SM075-0175				1.75				
CAT40-SM075-0400-B	CAT40-SM075-0400				4.00				
CAT40-SM075-0600-B	CAT40-SM075-0600	0.750	1.75	0.69	6.00	0.312	DK-SM075	3/8-24	SCW-SM075
CAT40-SM075-0800-B	CAT40-SM075-0800				8.00				
	CAT40-SM075-0900				9.00				
CAT40-SM100-0200-B	CAT40-SM100-0200				2.00				
CAT40-SM100-0400-B	CAT40-SM100-0400				4.00				
CAT40-SM100-0600-B	CAT40-SM100-0600	1.000	1.97	0.69	6.00	0.375	DK-SM100	1/2-20	SCW-SM100
	CAT40-SM100-0800				8.00				
CAT40-SM125-0225-B	CAT40-SM125-0225	1.250	2.87	0.69	2.25	0.500	DK-SM125	5/8-18	SCW-SM125
CAT40-SM150-0240-B	CAT40-SM150-0240	1.500	3.82	0.94	2.40	0.625	DK-SM150	3/4-16	SCW-SM150
	CAT40-SM200-0240	2.000	4.37	0.94	2.40	0.750	DK-SM200	1"-14	SCW-SM200

CAT 40

CAT50

BT30

BT40

HSK 40E

HSK 63A

HSK 100A

STRAIGHT SHANKS

COLLETS

PARTS & ACCESS.

SHRINK MACHINES

INDEXERS

