

# CAT40 Shrink Fit - Inch

## Features

- 3 μm - 0.0001" Runout Taper to Bore
- Manufactured from ISO-40CrMoV5 (H13) Material, Heat Treated for Optimum Elasticity and Tool Life
- X Jet-Blast Pluggable Coolant Ports
- Tapers are ground better than AT3 for optimal T.I.R.
- Dynamically Balanced for G2.5 @ 25,000 RPM or < 1 gmm
- Preset Screw included for 1/4" & larger for positive stop
- Designed for Carbide Cutting Tools with h6 shank tolerance

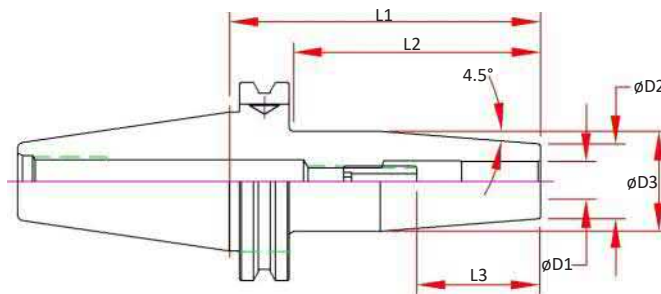

## Optional (Order Separately):

- Fine Trim Balance (Sample cutter required for balance compensation)



Dual Contact Spindle Part Number	Standard Spindle Part Number	D1 Bore	D2	D3	L1 Projection	L2	L3 Max Tool Enters	Preset Screw
CAT40-SD012-080-B-X	CAT40-SD012-080X	0.1250	0.39	0.77	3.15	2.28	4.57	-
CAT40-SD012-130-B-X	CAT40-SD012-130X	0.1250	0.39	0.77	5.12	4.25	6.70	-
CAT40-SD012-160-B-X	CAT40-SD012-160X	0.1250	0.39	0.77	6.30	5.43	7.73	-
CAT40-SD018-080-B-X	CAT40-SD018-080X	0.1875	0.39	0.77	3.15	2.28	4.57	-
CAT40-SD018-130-B-X	CAT40-SD018-130X	0.1875	0.39	0.77	5.12	4.25	6.70	-
CAT40-SD018-160-B-X	CAT40-SD018-160X	0.1875	0.39	0.77	6.30	5.43	7.73	-
CAT40-SD025-080-B-X	CAT40-SD025-080X	0.2500	0.83	1.06	3.15	2.28	1.54	SCW-ASC-05-23
CAT40-SD025-130-B-X	CAT40-SD025-130X	0.2500	0.83	1.06	5.12	4.25	1.54	SCW-ASC-05-23
CAT40-SD025-160-B-X	CAT40-SD025-160X	0.2500	0.83	1.06	6.30	5.43	1.54	SCW-ASC-05-23
CAT40-SD031-080-B-X	CAT40-SD031-080X	0.3125	0.83	1.06	3.15	2.28	1.54	SCW-ASC-06-23
CAT40-SD031-130-B-X	CAT40-SD031-130X	0.3125	0.83	1.06	5.12	4.25	1.54	SCW-ASC-06-23
CAT40-SD031-160-B-X	CAT40-SD031-160X	0.3125	0.83	1.06	6.30	5.43	1.54	SCW-ASC-06-23
CAT40-SD037-080-B-X	CAT40-SD037-080X	0.3750	0.94	1.26	3.15	2.28	1.73	SCW-ASC-08-23
CAT40-SD037-130-B-X	CAT40-SD037-130X	0.3750	0.94	1.26	5.12	4.25	1.73	SCW-ASC-08-23
CAT40-SD037-160-B-X	CAT40-SD037-160X	0.3750	0.94	1.26	6.30	5.43	1.73	SCW-ASC-08-23
	CAT40-SD043-080X	0.4375	0.94	1.26	3.15	2.28	1.73	SCW-ASC-08-23
CAT40-SD050-080-B-X	CAT40-SD050-080X	0.5000	0.94	1.26	3.15	2.28	1.97	SCW-ASC-10-23
CAT40-SD050-130-B-X	CAT40-SD050-130X	0.5000	0.94	1.26	5.12	4.25	1.97	SCW-ASC-10-23
CAT40-SD050-160-B-X	CAT40-SD050-160X	0.5000	0.94	1.26	6.30	5.43	1.97	SCW-ASC-10-23
CAT40-SD062-080-B-X	CAT40-SD062-080X	0.6250	1.06	1.34	3.15	2.28	2.09	SCW-ASC-12-23
CAT40-SD062-130-B-X	CAT40-SD062-130X	0.6250	1.06	1.34	5.12	4.25	2.09	SCW-ASC-12-23
CAT40-SD062-160-B-X	CAT40-SD062-160X	0.6250	1.06	1.34	6.30	5.43	2.09	SCW-ASC-12-23
CAT40-SD075-080-B-X	CAT40-SD075-080X	0.7500	1.30	1.65	3.15	2.28	2.09	SCW-ASC-12-23
CAT40-SD075-130-B-X	CAT40-SD075-130X	0.7500	1.30	1.65	5.12	4.25	2.09	SCW-ASC-12-23
CAT40-SD075-160-B-X	CAT40-SD075-160X	0.7500	1.30	1.65	6.30	5.43	2.09	SCW-ASC-12-23
	CAT40-SD087-080X	0.8750	1.30	1.65	3.15	2.28	2.09	SCW-ASC-12-23
CAT40-SD100-100-B-X	CAT40-SD100-100X	1.0000	1.73	2.09	3.94	3.07	2.28	SCW-ASC-16-23
CAT40-SD100-130-B-X	CAT40-SD100-130X	1.0000	1.73	2.09	5.12	4.25	2.28	SCW-ASC-16-23
CAT40-SD100-160-B-X	CAT40-SD100-160X	1.0000	1.73	2.09	6.30	5.43	2.28	SCW-ASC-16-23
CAT40-SD125-100-B-X	CAT40-SD125-100X	1.2500	1.73	2.09	3.94	3.07	2.28	SCW-ASC-16-23
CAT40-SD125-130-B-X	CAT40-SD125-130X	1.2500	1.73	2.09	5.12	4.25	2.28	SCW-ASC-16-23
CAT40-SD125-160-B-X	CAT40-SD125-160X	1.2500	1.73	2.09	6.30	5.43	2.28	SCW-ASC-16-23